



- L3V load cells are available in the capacities 200kg and 500kg.
- Aluminum material, sealed with silicon adhesive, surface spraying plastic with good resistance against corrosion.
- Integral construction, easy installation.
- Suitable for textile machinery measuring and other electronic measuring fields.

Features

- Capacity: 200kg, 500kg
- Aluminum S beam
- High accuracy
- High reliability



Specifications

Capacity	kg	200/500
Accuracy		C2
Maximum number of verification intervals	n _{max}	2000
Minimum load cell verification interval	v _{min}	E _{max} /5000
Combined error	(%FS)	≤ ±0.030
Creep	(%FS/30min)	≤ ±0.024
Temperature effect on sensitivity	(%FS/10°C)	≤ ±0.017
Temperature effect on zero	(%FS/10°C)	≤ ±0.023
Output sensitivity	(mv/v)	2.3±0.04
Input resistance	(Ω)	410±30
Output resistance	(Ω)	351±2
Insulation resistance	(MΩ)	≥5000(50VDC)
Zero balance	(%FS)	2
Temperature, compensated	(°C)	-10~+40
Temperature, operating	(°C)	-35~+65
Excitation, recommended	(V)	5~12(DC)
Excitation, max	(V)	18(DC)
Safe overload	(%FS)	150
Ultimate overload	(%FS)	300

Outline Dimension mm(inch)

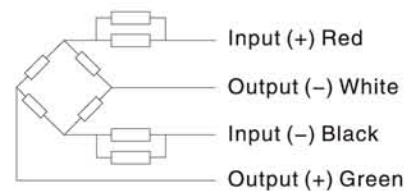
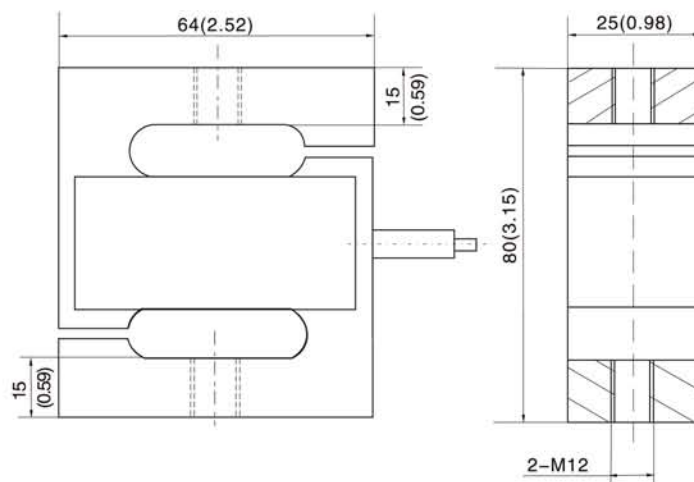

Wiring:

Adopt shielded, 4 conductor cable: $\Phi 5.3 \pm 0.2$ mm, and cable jacket is PVC.
Standard cable length: 2.6 ± 0.1 m