

RICHTER SCALE



H6G5

Visit www.load-cell.co.za • T +27 (0)12 386 3065 • E: loadcells@richterscale.co.za



- H6G5 load cells are available in the capacities 50kg~2000kg.
- Alloy steel construction, potted by adhesive inside, oil proof, waterproof, anti-corrosive gas and medium making it suitable for all kinds of environments.
- Single point with parallel beam, suitable for electronic scales, platform scales, belt scales and other electronic weighing devices.
- Max. platform size:
50kg~1t 600×800mm
1.5t~2t 1000×1000mm

Features

- Capacity: 50kg~2000kg
- High accuracy
- Alloy steel construction
- Low profile and easy installation



Specifications

Capacity	t	0.05/0.1/0.15/0.2/0.25/0.3/0.4/0.5/0.6/0.75/1/1.5/2	
Accuracy		C2	C3
Maximum number of verification intervals	n _{max}	2000	3000
Minimum load cell verification interval	v _{min}	E _{max} /5000	E _{max} /10000
Combined error	(%FS)	≤ ±0.030	≤ ±0.020
Creep	(%FS/30min)	≤ ±0.024	≤ ±0.016
Temperature effect on sensitivity	(%FS/10°C)	≤ ±0.017	≤ ±0.011
Temperature effect on zero	(%FS/10°C)	≤ ±0.023	≤ ±0.015
Output sensitivity	(mv/v)	2.0±0.002	
Input resistance	(Ω)	384±4	
Output resistance	(Ω)	351±2.0	
Insulation resistance	(MΩ)	≥5000(50VDC)	
Zero balance	(%FS)	1.5	
Temperature, compensated	(°C)	-10~+40	
Temperature, operating	(°C)	-35~+65	
Excitation, recommended	(V)	5~12(DC)	
Excitation, max	(V)	18(DC)	
Safe overload	(%FS)	150	
Ultimate overload	(%FS)	300	
Corner correction		0.02%load value/100mm	

Outline Dimension mm(inch)

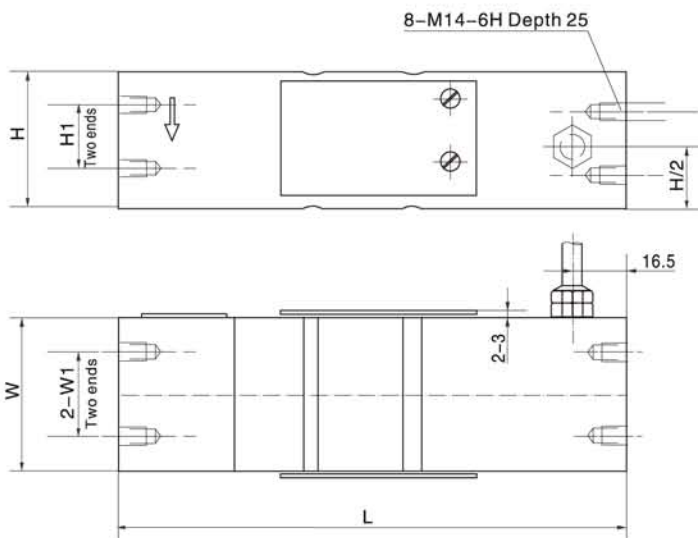

Capacity	50kg ~ 1t	1.5t ~ 2t
Dimension		
L	150(5.91)	150(5.91)
H	77(3.03)	88(3.46)
H1	46(1.81)	55(2.17)
W	68(2.68)	76(2.99)
W1	38(1.50)	42(1.65)

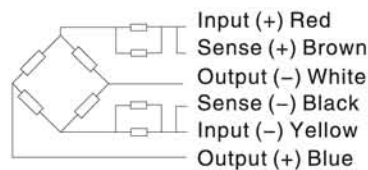

Wiring:

Adopt shielded, 6 conductor cable: Φ6.2mm
Standard cable length: 3m