

RICHTER SCALE

FEATURES

- Nickel plated alloy steel IP67 dual shear beam load cell
- High accuracy
- Suitable for truck and track scales and other heavy weighing devices
- Sealed construction



AVAILABLE MODELS

xxklb	C3	B9D-C3-xxK-9B
xxklb	C3/C4/C5/A5M/B10M	H9D-xx-xxK-9B
1.8t-7.5t (4klb-15klb) approved by OIML C4.		
9t-35t (19.8klb-70klb) approved by OIML C5.		
20klb-75klb approved by NTEP A5M/B10M.		

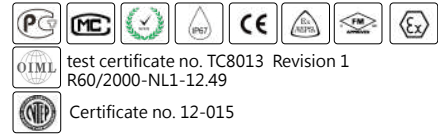

SPECIFICATION

Maximum capacity (E _{max})	klb	1/1.5/2/2.5/4/5/10/15/20/25/35/50/75			
Accuracy class		C3	C4	A5M	B10M
Approvals			OIML R60 C4	III 5000 Multiple	IIIL 10000 Multiple
Maximum number of load cell intervals (nLC)		3000	4000	5000	10000
Ratio of minimum LC verification interval Y=E _{max} / V _{min}		10000	14000	15000	10000
Combined error	%FS	±0.020	±0.018	±0.026	±0.050
Creep	%FS/30min	±0.016	±0.012	±0.017	±0.040
Temperature effect on sensitivity	%FS/10°C	±0.011	±0.009	±0.013	±0.040
Temperature effect on zero	%FS/10°C	±0.015	±0.010	±0.014	±0.020
Output sensitivity (=FS)	mV/V	3.0±0.008			
Input resistance	Ω	700±7			
Output resistance	Ω	703±4			
Insulation resistance	MΩ	≥ 5000 (50VDC)			
Zero balance	%FS	±1.0			
Temperature, compensated	°C	-10~+40			
Temperature, operating	°C	-35~+70			
Excitation, recommended voltage	V	5~12 (DC)			
Excitation maximum	V	18 (DC)			
Safe overload	%FS	150			
Ultimate overload	%FS	300			
ATEX classification (optional)		IIIG Ex ia IIIC T4	IIID Ex iaD20 T73°C	IIIG Ex nL IIC T4	

Note: accuracy for B9D is C3, no OIML or NTEP approvals available.

DIMENSIONS IN MM

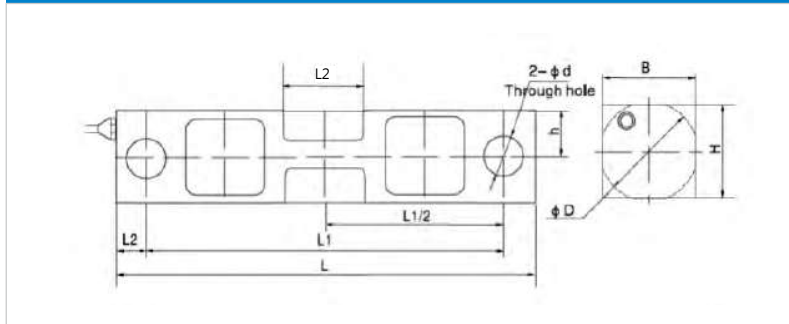

Dimension Capacity	L	L1	L2	H	h	B	ΦD	Φd
1Klb-5Klb	190.5 (7.5)	158.75 (6.25)	15.9 (0.63)	30.99 (1.22)	16.76 (0.66)	30.99 (1.22)	31.5 (1.24)	12.7 (0.5)
10Klb-35Klb	222.25 (8.75)	190.5 (7.5)	15.9 (0.63)	49.15 (1.94)	24.58 (12.67)	36.45 (1.44)	50.8 (2.0)	20.57 (0.81)
50Klb-75Klb	342.9 (13.5)	292.1 (11.5)	25.4 (1.0)	74.68 (2.94)	37.37 (1.47)	61.98 (2.44)	75.95 (2.99)	33.32 (1.31)

WIRING

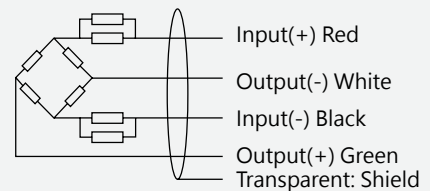

- Shielded, 4 conductor cable.
- Cable diameter: Φ5mm.
- Standard cable length: 6m.
- Shield is not connected to element.